



41 Bay Road Oatley NSW

3 1 2

This beautiful cottage is situated in a sought after location overlooking a picturesque peaceful tree lined street.

This quaint and pretty cottage has beautiful original features and could easily be transformed into the home of your dreams. A peaceful and large backyard is sun drenched and the home has a commanding position above street level giving you a gorgeous outlook.

All rooms are well sized and light filled with the bonus addition of a downstairs one bedroom granny flat and large storage area.

- 3 bedrooms
- 1 bathroom
- 2nd toilet
- 2 car carport

Price : \$ 1,180,000
Land Size : 490 sqm
View : <https://www.dashamcgeeproperty.com.au/sale/nsw/st-george/oatley/residential/house/6186966>



Dasha McGee
0433 044 240

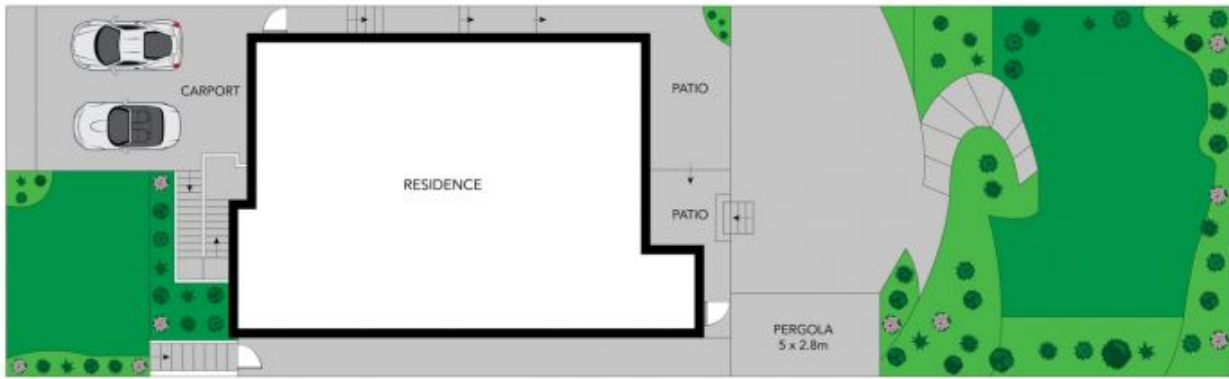

INT: 211 m²
EXT: 371 m²



This floor plan was prepared by WWW.CRYINGOUTLOUD.COM.AU for illustration purposes only. This document does not constitute any part of an offer or contract. Dimensions are approximate only.

41 Bay Road, Oatley