



### 3 Blackwattle Place Alfords Point NSW

5 🚗 3 🚗 4 🚗

This stunning residence is a touch of Tuscany in Alfords Point sitting on an impressive 987sqm of landscaped grounds with gorgeous district views all the way to the mountains and the City. Enjoy watching the beautiful sunsets every night or the fireworks on New Years Eve.

You will be impressed the moment you walk into this stunning home with it's grand entrance boasting plenty of living space, extra large bedrooms, gorgeous alfresco outdoor entertainment area and the stunning in-ground swimming pool & poolside cabana.

Situated in a peaceful quiet cul-de-sac in a much sought after location, this property is a must to inspect - it's simply beautiful in every way.

- 5 over sized bedrooms all with built-inns

**Price** : \$ 1,720,000  
**Land Size** : 989 sqm  
**View** : <https://www.dashamcgeeproperty.com.au/sale/nsw/sutherland/alfords-point/residential/house/6186975>



**Dasha McGee**  
0433 044 240



GROUND FLOOR



FIRST FLOOR

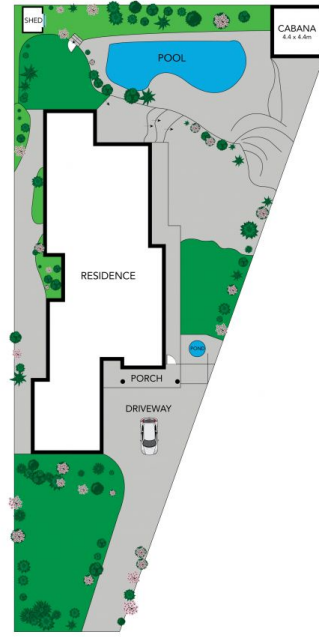

SITE PLAN  
(NOT TO SCALE)



INT: 454 m<sup>2</sup>  
EXT: 825 m<sup>2</sup>



This floor plan was prepared by WWW.CRYPINGOUTLOUD.COM.AU for illustration purposes only. This document does not constitute any part of an offer or contract. Dimensions are approximate only. Copyright © 2017 Crying Out Loud. All Rights Reserved.

3 Black Wattle Place, Alfords Point