

585 Princes Highway Kirrawee NSW

3 1 3

This conveniently located home is within walking distance to the train station, shopping centre, many restaurants, child care facilities and the Prince Hotel.

Located off the main road via a private entry road there is ample parking and privacy. Current roadworks will only enhance this property with the expectation to be finalised by the end of the year, so get in now and capitalise on the future improvements.

There is a lovely covered outdoor deck facing north which is the ideal spot for outdoor entertaining.

Timber floorboards throughout and ceiling fans compliment this 3 bedroom home sun filled home.

ACCESS: Via Kenneth Ave. Drive to end of Kenneth Ave,

Price : \$ 782,000

View : <https://www.dashamcgeeproperty.com.au/sale/nsw/sutherland/kirrawee/residential/house/6187014>



Dasha McGee
0433 044 240



Julie Murray
0402 977 394

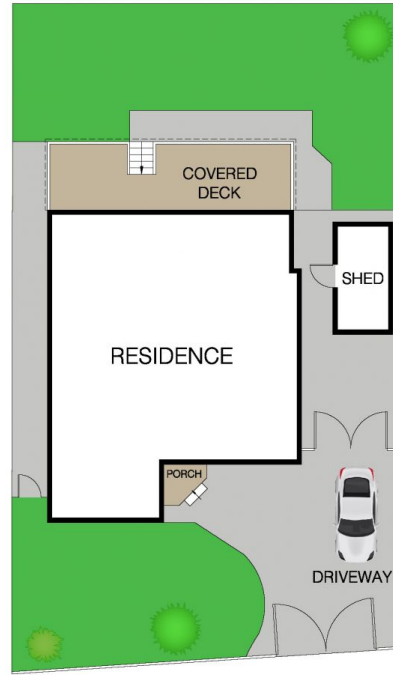

SITE PLAN (NOT TO SCALE)



INT: 89m²
EXT: 25m²



This Floor Plan was prepared by WWW.CRYINGOUTLOUD.COM.AU for illustration purposes only. This document does not constitute any part of an offer or contract. Dimensions are approximate only. Copyright © 2020 Crying Out Loud. All Rights Reserved.

585 Princes Highway, Kirrawee